

Aria 2

Projectors | IP40 | Class III | Dimmable

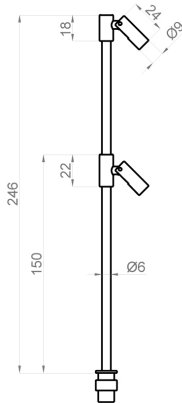
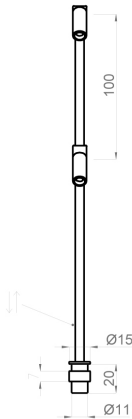

LIGHT SOURCE & OPTIC

Power

1W
2W

Lens

20°/30°/50°

Beam Direction

Adjustable: +/- 120°, rotating +/- 355°
Symmetrical

Material

PMMA

LED quantity

2

Binning

2 MacAdam steps

Color temperature & quality

2200K CRI>80
2700K CRI>90
3000K CRI>90
3500K CRI>90
4000K CRI>90

Lifetime

(L90) >60.000 hrs

FIXTURE

Dimensions

Ø 9mm x H 24mm (cylinder)

Material

Aluminium

Body finishes

Black (RAL 9005)
Gold Chrome
Grey (RAL 7012)
Shiny Chrome
Champagne gold

Weight

80gr

Mounting

On surface

Fixing

Ring Nut

Working temperature

-20° / +40°

ELECTRICAL FEATURES

Power supply

Main Voltage:
350 mA
500 mA
Typical Vf=3V

Driver requirement

Remote (not included)

Control

On/off
Push switch
Phase Cut
0/1-10 V
Casambi
DALI

Aria 2

PHOTOMETRIC DATA (3000K CRI>90)

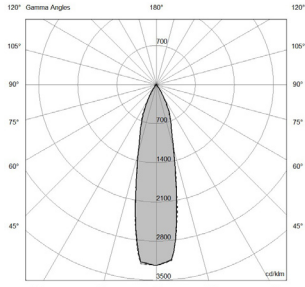
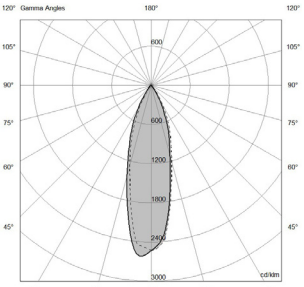
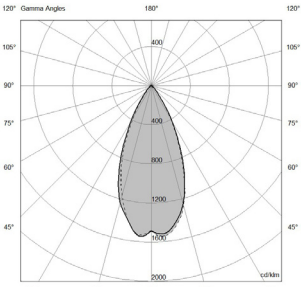
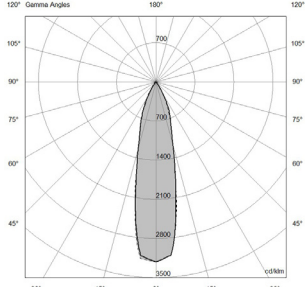
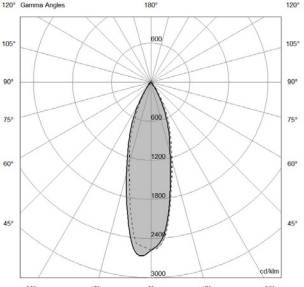
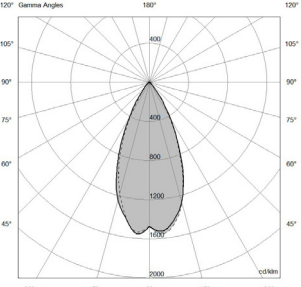
1W - 20° UGR 23			1W - 30° UGR 25			1W - 50° UGR 26		
								
H (m)	D (m)	Eav (lx)	H (m)	D (m)	Eav (lx)	H (m)	D (m)	Eav (lx)
1	0.44	107	1	0.52	74	1	0.87	37
2	0.88	27	2	1.04	19	2	1.75	9
3	1.32	12	3	1.56	8	3	2.62	4
4	1.77	7	4	2.07	5	4	3.50	2
5	2.21	4	5	2.59	3	5	4.37	1
Total lumen output 51 lm			Total lumen output 46 lm			Total lumen output 41 lm		
Efficacy 52 lm/W			Efficacy 47 lm/W			Efficacy 41 lm/W		
2W - 20° UGR 27			2W - 30° UGR 25			2W - 50° UGR 26		
								
H (m)	D (m)	Eav (lx)	H (m)	D (m)	Eav (lx)	H (m)	D (m)	Eav (lx)
1	0.44	141	1	0.52	97	1	0.87	48
2	0.89	35	2	1.04	24	2	1.74	12
3	1.31	16	3	1.56	11	3	2.62	5
4	1.75	9	4	2.08	6	4	3.49	3
5	2.19	6	5	2.60	4	5	4.36	2
Total lumen output 67 lm			Total lumen output 59 lm			Total lumen output 54 lm		
Efficacy 34 lm/W			Efficacy 30 lm/W			Efficacy 27 lm/W		

SUGGESTED REMOTE DRIVER

On/off:
CC20-F-350-N / CC20-F-500-N

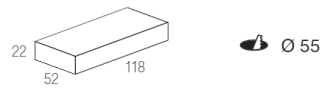

Multifunction (DALI 2, 0/1-10V, PUSH):
CC25-DM-350-N / CC25-DM-500-N

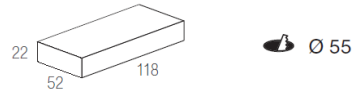

Other options upon request